

# MY BARBARA



BARBARA - TIMELESS LADY FOR A MOST MEMORABLE LUXURY CHARTER



# CHARTER PRICE INCLUDES

- 7 day cruise trip around the Dalmatian coast and islands
- Accommodation in 16 cabins
- Welcome drinks
- 8 members of the crew
- Room cleaning every day,
- Agents commission
- Port taxes
- Use of hydro-massage pool for 6 people
- Water toys / 4 paddleboards / sea bob
- Free WiFi.
- VAT



# OPTIONAL SERVICES

- Creation of own cruising route
- Cruise manager on board
- Selection of menus
- Massage on board
- Visit of national parks
- Transfers
- Guided tours
- Food & Wine tours
- Incentive programs / Business meetings
- Events
- Weddings

## FOOD OPTION

- Obligatory - Half board  
(breakfast plus 1 meal per day-lunch)





# CREW

- Captain
- First engineer
- 2 Sailors
- Waiter
- Chef
- Chef's assistant
- Hostess / chambermaid





# TEHNNICAL SPECIFICATION

- Year 2006, interior refit 2018, exterior refit 2024
- Hull material: Stainless steel
- Deck material: Teak
- Superstructure: Mahogany
- Type: Motor Sailor
- Engine: Two Baudouin type engines, 400Hp each
- Generator:
  - Cummins Onan 27 kW
  - Cummins Onan 19 kW
  - Caterpillar 12 kW
- 220 Volt shore supply
- Speed: 10/12 Kn
- Flag: Croatian
- LOA: 43 m (141 ft)
- Beam: 8,35 m (27'4 ft)
- Draft: 3,50 m (11'48 ft)
- Fuel tanks: 10 m<sup>3</sup>
- Water tanks: 80 m<sup>3</sup>
- Sewage water: 9 m<sup>3</sup>
- SIMRAD Autopilot
- GPS GARMIN & Speed Log
- SIMRASD Radar
- VHF radio station
- Echo sounder
- Standard SOLAS navigation
- Two horseshoe buoys with warning lights
- SOLAS life jackets as capacity in each cabin
- Automatic inflatable life raft
- Central fire alarm
- Smoke detectors in each cabin
- Portable fire extinguishers in corridors and salon
- Engine aerosol fire extinguishers
- Home port: Split, Croatia

# LOWER DECK CABINS

- 01 – double bed+1/1extra, 19,5 m<sup>2</sup>
- 02 – double bed, 15,2 m<sup>2</sup>
- 03 – double bed, 13,3 m<sup>2</sup>
- 04 – double bed+1/1extra, 19,5 m<sup>2</sup>
- 05 – double bed, 13,3 m<sup>2</sup>
- 06 – double bed+1/1extra, 15,2 m<sup>2</sup>

# MAIN DECK CABINS

- 07 – twin beds, 12,0 m<sup>2</sup>
- 08 – twin beds, 12,0 m<sup>2</sup>
- 09 – twin beds, 14,2 m<sup>2</sup>
- 10 – twin beds, 14,2 m<sup>2</sup>
- 11 – twin beds, 13,5 m<sup>2</sup>
- 12 – twin beds, 13,5 m<sup>2</sup>
- 13 – double bed, 14,5 m<sup>2</sup>
- 14 – double bed, 14,5 m<sup>2</sup>
- 15 – double bed, 17,3 m<sup>2</sup>
- 16 – double bed, 17,3 m<sup>2</sup>



# SUN DECK

- salon restaurant
- terrace with lounge and dining area
- salon for crew
- kitchen
- sun deck area
- hydro-massage pool for 6 people
- sunbathing area with loungers
- main bridge





# RECREATIONAL EQUIPMENT

- Tender Rismarine 5,99 m, 115 Hp outboard Suzuki engine
- Tender 3,0 m, 8 Hp outboard Suzuki engine
- Snorkelling equipment
- Fishing equipment
- Diving with professional diver – extra charge
- Doughnuts for rent
- Water skiing for rent
- Jet ski for rent
- Sea bob
- 4 paddleboards
- Yacht Beach Platforms premium teak



PRIVACY  
IS THE MOST  
IMPORTANT



# BARBARA LAYOUTS

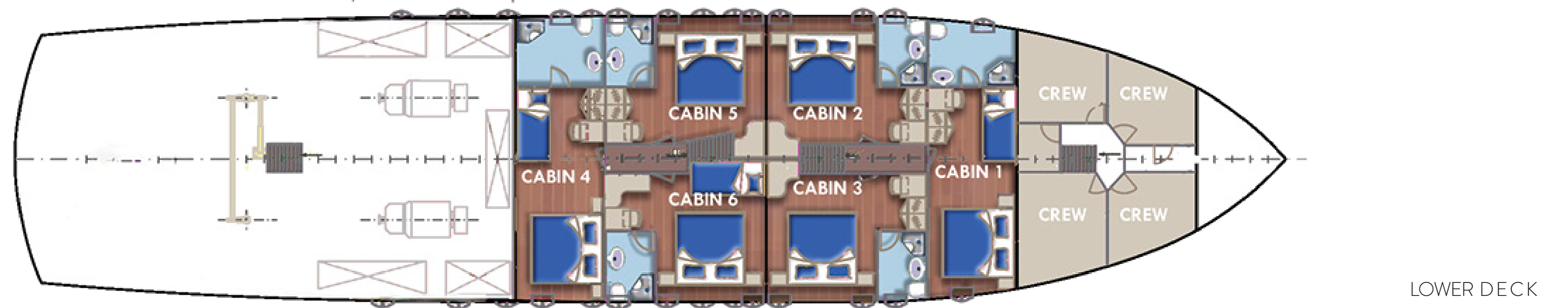
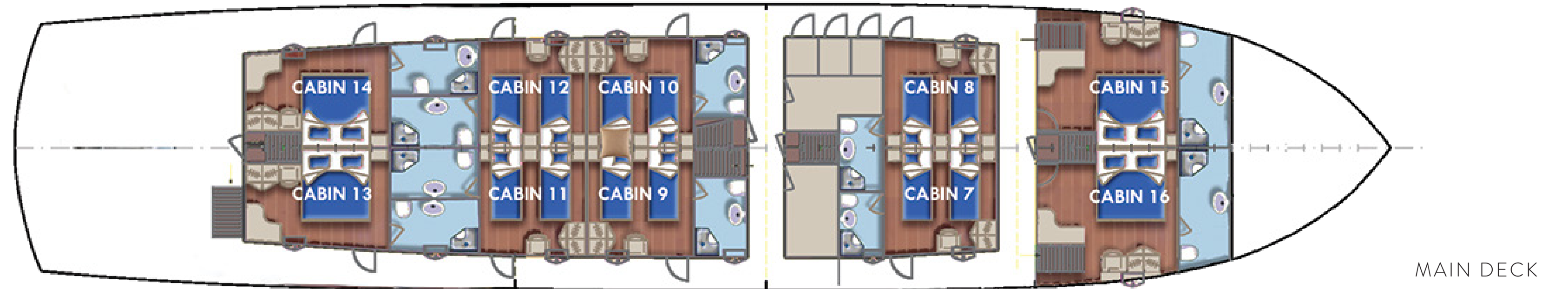
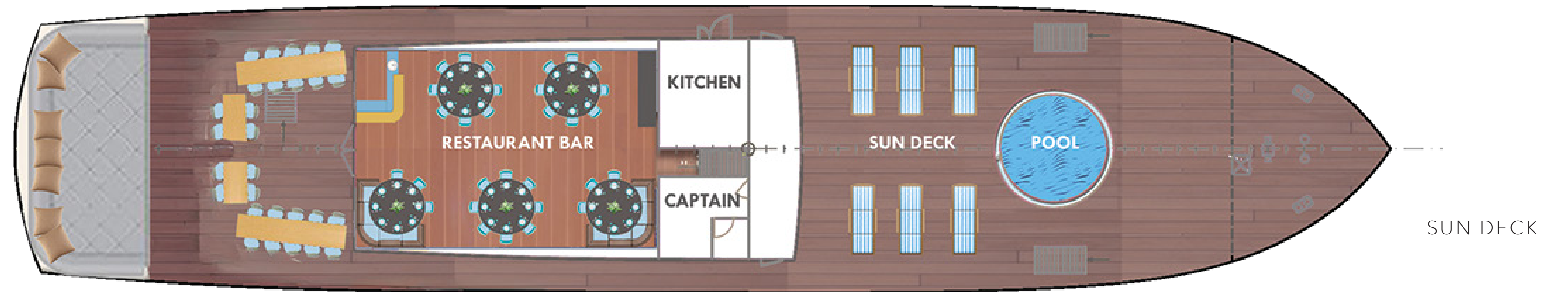

MY  
BARBARA

